



Sarah Bush Lincoln Health Center is a **tobacco-free** campus.

Thank you for your cooperation.

| | | |
|----------------------------------|---------------------------|----------------|
| Sarah Bush Lincoln Health Center | Prairie Pavilion 1 | Surgery Center |
| Professional Plaza | Prairie Pavilion 2 | |
| Regional Cancer Center | Center for Healthy Living | |

DEPARTMENTS & AREAS

- | | |
|---|---|
| 8 Center for Healthy Living | 36 Pediatric Clinic |
| 14 Family Practice (Ranchero) | 37 Physical & Occupational Therapy |
| 15 Fitness Center | 38 Prairie Family Practice |
| 18 Human Resources | 40 Psychiatry & Counseling |
| 19 Internal Medicine (Vassay/Winograd) | 42 Regional Cancer Center |
| 21 Lincolnland Home Care | 43 Sleep Disorders Center |
| 22 Lincolnland Hospice | 45 Surgery Center |
| 27 Occupational Medicine | 51 Weight Management Program |
| 28 Orthopedics & Sports Medicine | 52 Wellness Services |

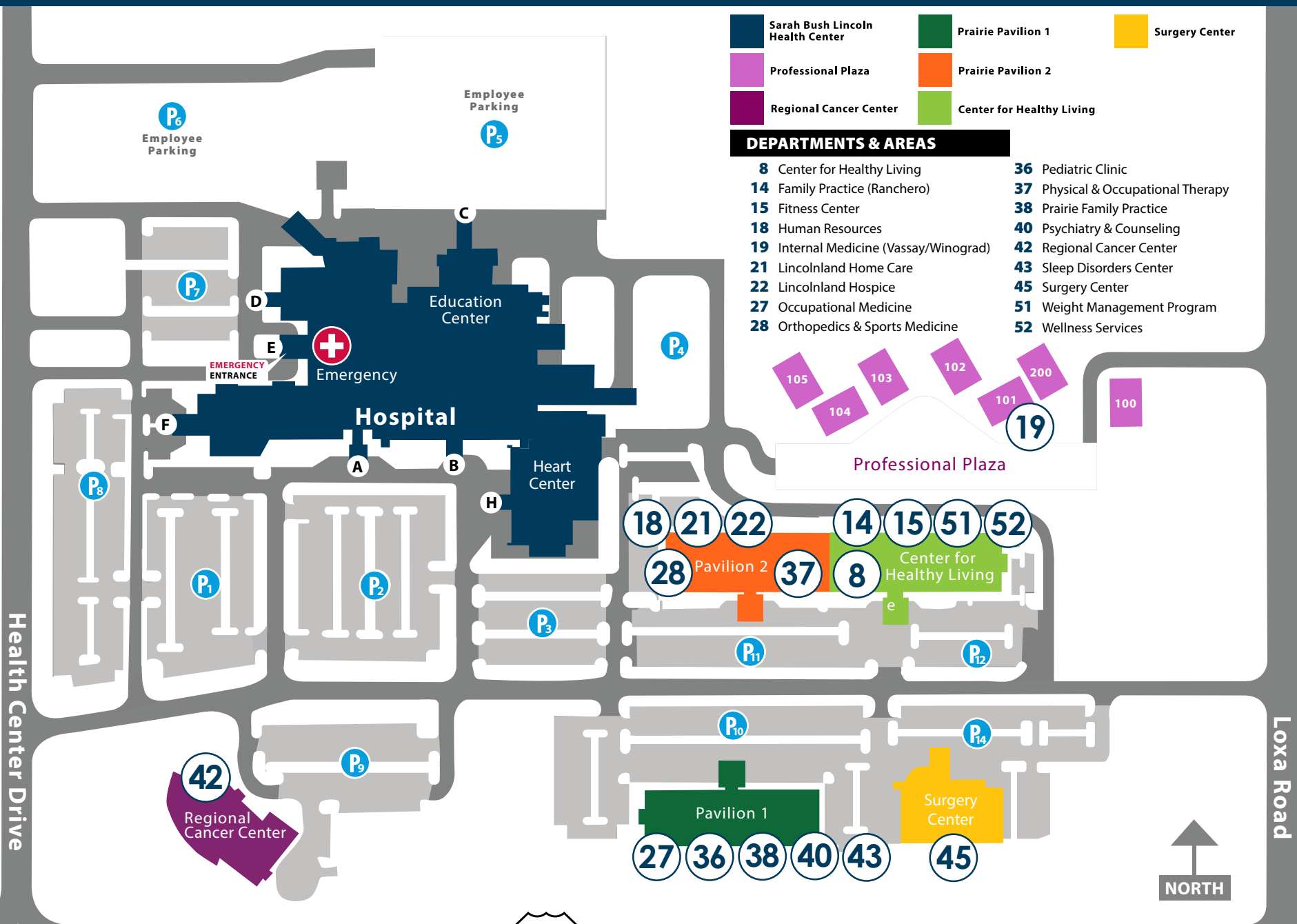

MAIN CAMPUS

16 Illinois Route 16

DEPARTMENTS AND AREAS

| Loc | Destination | Floor | Bldg | Loc | Destination | Floor | Bldg |
|-----|--|-------|------|-----|------------------------------------|-------|------|
| 1 | Administration & Foundation | 3 | H | 29 | Outpatient Laboratory | 1 | H |
| 2 | Advanced Wound Center | 3 | H | 30 | Patient Financial Services/Cashier | 1 | H |
| 3 | Audiology (Hearing) | 4 | H | 31 | Patient Rooms 2 East | 2 | H |
| 4 | Chapel | 1 | H | 32 | Patient Rooms 2 South | 2 | H |
| 5 | Cafeteria/The Basement Bistro | G | H | 33 | Patient Rooms 3 East | 3 | H |
| 6 | Cardiac & Pulmonary Rehab/METS | 1 | H | 34 | Patient Rooms 3 West | 3 | H |
| 7 | Cardiac Catheterization Lab | 1 | H | 35 | Patient Rooms 4 Medical | 4 | H |
| 8 | Center for Healthy Living | | CHL | 36 | Pediatric Clinic | 1 | PP1 |
| 9 | Center for Interventional Pain | 1 | H | 37 | Physical & Occupational Therapy | 1 | PP2 |
| 10 | Critical Care Unit | 1 | H | 38 | Prairie Family Practice | 1 | PP1 |
| 11 | Diagnostic Imaging | 1 | H | 39 | Prairie Medical Pharmacy | 1 | H |
| 12 | EMERGENCY | 1 | H | 40 | Psychiatry & Counseling | 1 | PP1 |
| 13 | ENT Clinic | 4 | H | 41 | Registration/Admitting | 1 | H |
| 14 | Family Practice (Ranchero) | 2 | CHL | 42 | Regional Cancer Center | | RCC |
| 15 | Fitness Center | 1 | CHL | 43 | Sleep Disorders Center | 1 | PP1 |
| 16 | Gastroenterology & Special Procedures | 2 | H | 44 | Speech and Hearing | 4 | H |
| 17 | Gift Shop | 1 | H | 45 | Surgery Center | | SC |
| 18 | Human Resources | 2 | PP2 | 46 | Surgery Clinic | 1 | H |
| 19 | Internal Medicine (Vassay/Winograd) | 1 | 101 | 47 | Surgical Services | 1 | H |
| 20 | Library | G | H | 48 | The Heart Center | 1 | H |
| 21 | Lincolnland Home Care | 2 | PP2 | 49 | Urology Clinic | 3 | H |
| 22 | Lincolnland Hospice | 2 | PP2 | 50 | Volunteer Services | G | H |
| 23 | Lumpkin Family Center for Health Education | G | H | 51 | Weight Management Program | 1 | CHL |
| 24 | Medical Record Management | G | H | 52 | Wellness Services | 1 | CHL |
| 25 | MRI | 1 | H | 53 | Women & Children's Center | 2 | H |
| 26 | Neurology Clinic | 1 | H | 54 | Women's Healthcare | 2 | H |
| 27 | Occupational Medicine | 1 | PP1 | 55 | Women's Imaging Center | 1 | H |
| 28 | Orthopedics & Sports Medicine | 1 | PP2 | | | | |

LEGEND



**HOSPITAL
FIRST
FLOOR**

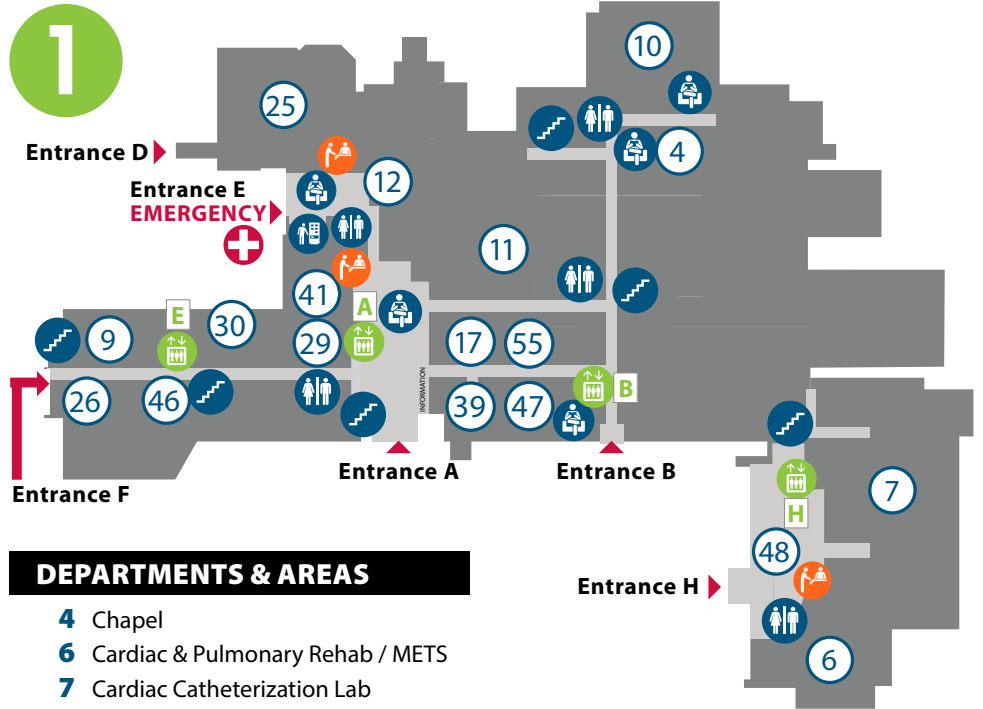

DEPARTMENTS & AREAS

- 4 Chapel
- 6 Cardiac & Pulmonary Rehab / METS
- 7 Cardiac Catheterization Lab
- 9 Center for Interventional Pain
- 10 Critical Care Unit
- 11 Diagnostic Imaging
- 12 **Emergency**
- 17 Gift Shop
- 25 MRI
- 26 Neurology Clinic
- 29 Outpatient Laboratory
- 30 Patient Financial Services / Cashier
- 39 Prairie Medical Pharmacy
- 41 Registration/ Admitting
- 46 Surgery Clinic
- 47 Surgical Services
- 48 The Heart Center
- 55 Women's Imaging Center

**HOSPITAL
SECOND
FLOOR**

2

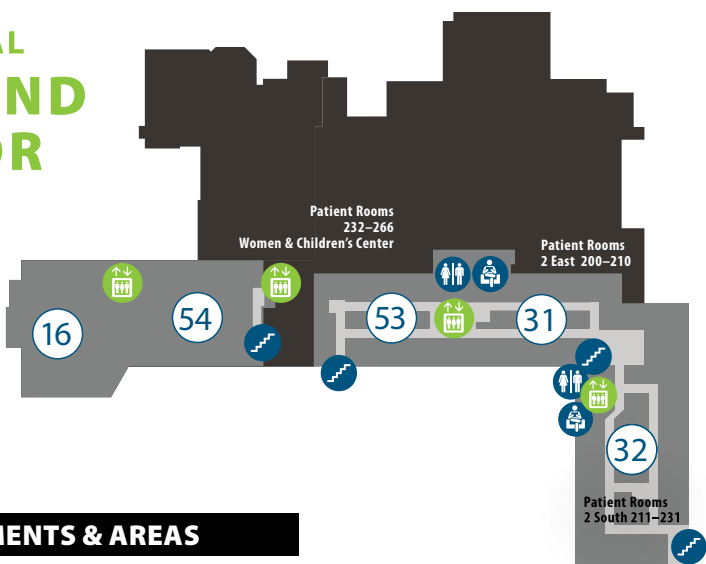

DEPARTMENTS & AREAS

- 16 Gastroenterology & Special Procedures (use elevator E)
- 31 Patient Rooms – 2 East
- 32 Patient Rooms – 2 South
- 53 Women & Children's Center
- 54 Women's Healthcare (use elevator A)

**HOSPITAL
THIRD
FLOOR**

3

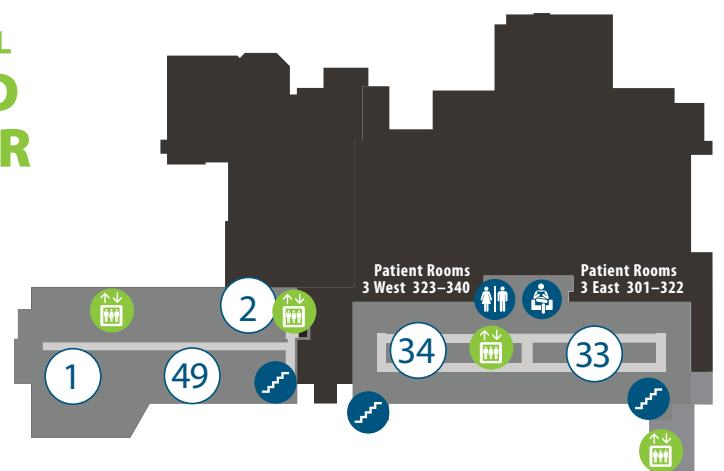

DEPARTMENTS & AREAS

- 1 Administration & Foundation
- 2 Advanced Wound Center
- 33 Patient Rooms – 3 East
- 34 Patient Rooms – 3 West
- 49 Urology Clinic

**HOSPITAL
FOURTH
FLOOR**

4



DEPARTMENTS & AREAS

- 3 Audiology (Hearing)
- 13 ENT Clinic
- 35 Patient Rooms – 4 Medical
- 44 Speech

**HOSPITAL
GROUND
FLOOR**

G

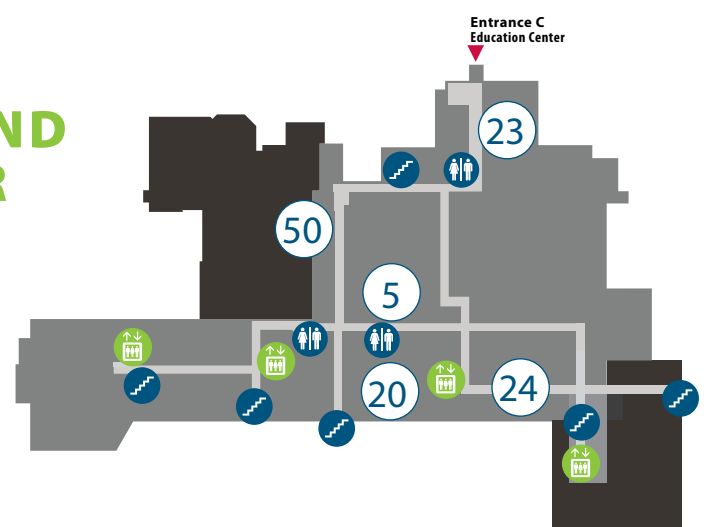

DEPARTMENTS & AREAS

- 5 Cafeteria / The Basement Bistro
- 20 Library
- 23 Lumpkin Family Center for Health Education
- 24 Medical Record Management
- 50 Volunteer Services